

## F L O A T I N G   S Y S T E M

### SYSTEM FEATURES AND BENEFITS

A floating sports floor system with high resiliency and uniformity, consisting in general of a vapor barrier, NeoShok resilient pads, wood subflooring, maple flooring, sanding, sealers, finishes, game lines and wall base.

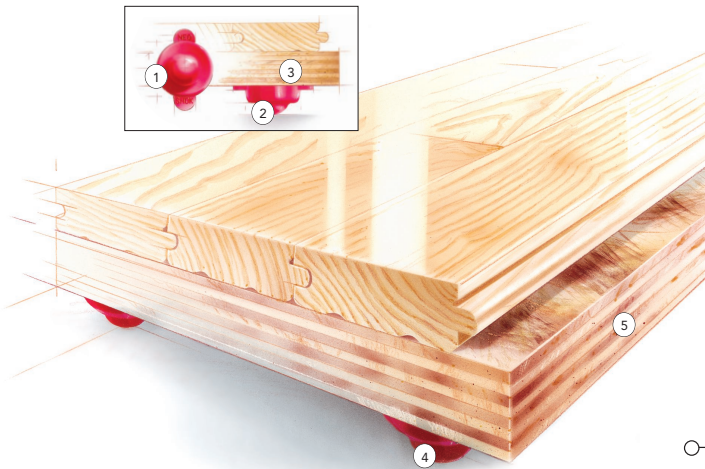

- ① Two-Stage NeoShok Pad
- ② First stage responsive to light loads
- ③ Second stage responsive to aggressive loads
- ④ Quick response contact point and excellent resilient load performance
- ⑤ Two layers of 15/32" (12mm) APA rated plywood subfloor

### SPECIFICATIONS

<b>MANUFACTURING</b>	<b>ISO9001:2000</b> CERTIFIED
<b>U.S. PATENT #</b>	4,879,857
<b>SYSTEM TYPE</b>	Floating System
<b>ANCHORAGE</b>	No concrete attachment
<b>SUBFLOOR CONSTRUCTION</b>	Plywood Panel
<b>RESILIENCE</b>	Polyurethane NeoShok Pads
<b>SLAB DEPRESSION</b>	25/32" (20 mm) flooring - 2 1/2" (64 mm) 33/32" (26 mm) flooring - 2 3/4" (70 mm)
<b>TESTING LABORATORY</b>	United States Sports Surfacing Laboratory 
<b>CERTIFIED TESTING</b>	Laboratory test equipment calibrated and certified through the ISSS 
<b>GREEN STATUS</b>	Managed forests, certification available

#### WALL BASE DETAIL

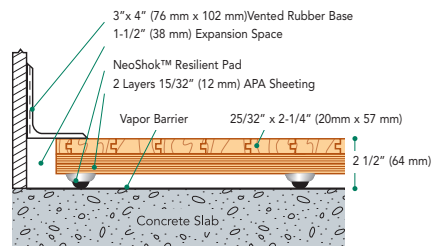

#### THRESHOLD DETAIL (optional accessory)

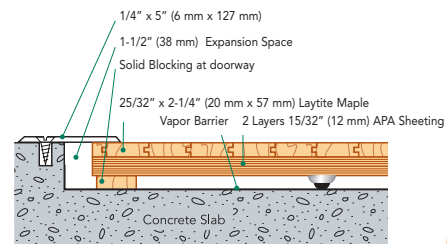

#### EQUIPMENT DETAIL (optional accessory)

